



HDX-2024

Dakota Digital Universal HDX Instrument Installation

Your new HDX-2024 kit includes:

HDX Display



Interconnect Harness



2X Y Harnesses



2X Extension Harnesses



2X Terminator Harnesses



(6x) L-Brackets and (x14) Thumb Nuts

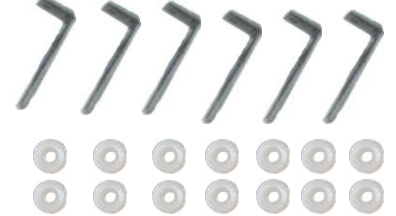

Universal Sender Pack



Buzzer



Installation Manuals



Main Harness

Control Box



Mounting Cups



Gaskets

Installation

Mounting

1. *Main gauges:* Mark out two 4.6” openings needed to fit the main gauges. Drill two 4.6” diameter mounting holes. Each display unit needs approximately 3” of depth behind the dash.
2. *Satellite gauges:* Mark out four 2.1” openings needed to fit the satellite gauges. Drill four 2.1” diameter mounting holes. The display units need approximately 2.6” of depth behind the dash.

Main Gauge Dimensions

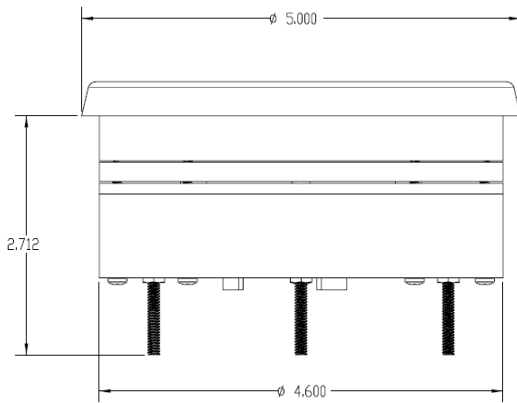

Satellite Dimensions

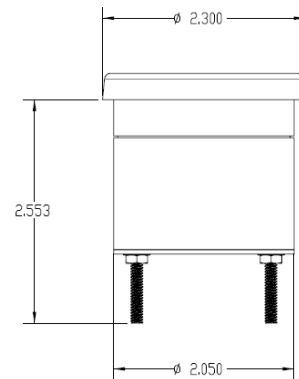

3. *Main gauges continued:* With the appropriate openings cut, place the HDX displays into the dash from the front and attach the six (6) L-brackets to the back of the displays using the provided thumb nuts.

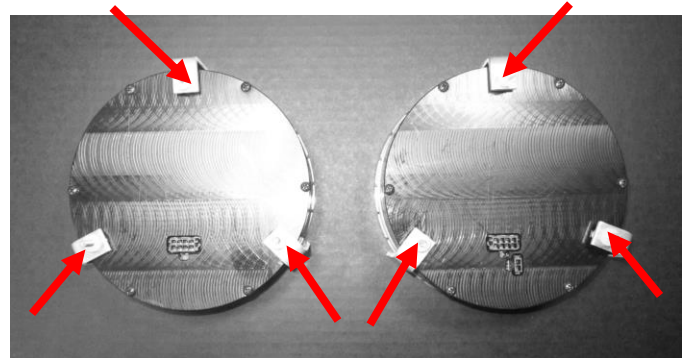

Satellite gauges continued: With the appropriate openings cut, place the satellites into the dash. From the back side of the dash, place the gaskets over the rear of each gauge. Place the four (4) mounting cans over the rear of the satellite. Use the provided thumb nuts to secure.



Wire harness connections:

4. The diagram below shows the standard wire harness connections for this system. Also included with this system are extension harnesses and terminator harnesses. The extension harnesses can be used to extend the length of any of the harnesses. The terminator harnesses are used in place of a gauge if you opt to remove or not use one or more of the included gauges.

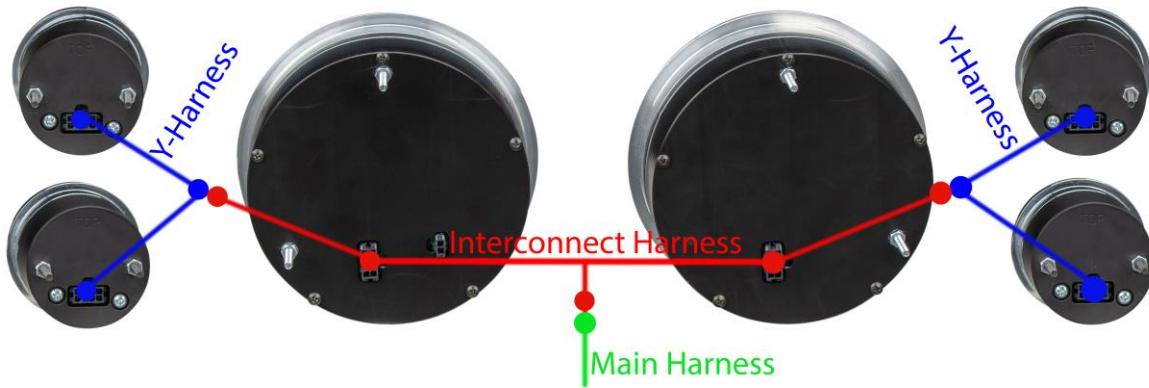

5. Connect the provided main harness to the interconnect harness and refer to the main manual for wiring instructions to complete the HDX installation. Also included is an optional buzzer that can be connected for audible feedback. This can be connected to the 2-pin connector on the rear of the speed gauge.

⚠️WARNING: This product can expose you to chemicals including lead, which is known to the State of California to cause cancer and birth defects or other reproductive harm. For more information go to www.P65Warnings.ca.gov



4510 W. 61st St. North
Sioux Falls, SD 57107
www.dakotadigital.com
dakotasupport@dakotadigital.com

Phone (605) 332-6513
Fax (605) 339-4106

© Copyright 2019 - Dakota Digital